

Lilly's furniture



Feel free to sell Your finished items. Mass production is - of course - not permitted. Do not copy, alter, share, publish or sell pattern, pictures or images. Copies be made for owner's personal use only.

* * *

ATTENTION: Please be aware that I only share my patterns via www.zhaya.de/ www.zhaya.eu. If you have downloaded this FREE pattern from anywhere else, please delete it immediately - as there are sites where anonymous hackers upload pattern files containing viruses, allowing them to access your computer and steal your personal and financial details.

Materials:

- Wool - for the furniture you can really use every wool you want (I used for cabinet and armchair ICE Yarn Magic Glitz (DK weight), I needed about 200 g, I used for the nightstand Schachenmayr Catania/Scheepjes Catona (Sport weight) - same as for Lilly's bed (Fb. 258, 518), less than a ball each, for the rocking bear about 40 g Lana Grossa Estivo II (worsted weight, a bit fluffy), some Schachenmayr Catania/Scheepjes Catona (Fb. 404, 179, 110), thread white
- Crochet hook in suitable size (for me: 2.0 mm, 2.2 mm - armchair; 3.5 mm - cabinet)
- Solid cardboard, plastic sheets, thin handicraft wood or something like that as basis for the furniture
- Cabinet: 4 wooden beads for the cabinet feet (for me: 25 mm diameter), 1 wooden beads as handle (for me: 20 mm diameter), 8 small wooden beads as brackets for the shelves (for me: 10 mm diameter, smaller beads are also fine) - you can replace all the wooden beads with crocheted or whatever you want
- Armchair: 4 wooden beads as armchair feet (for me: 25 mm diameter)
- Nightstand: 4-5 wooden beads (20 mm diameter), possibly 1 button instead the fifth bead
- Rocking bear: 2 wooden sticks (e. g. from popsicles) < — if you use thicker yarn the bear gets bigger, popsicle sticks are not enough. Maybe you can use some cardboard, wire, handicraft wood or something like that instead of these sticks; something to weigh down, e. g. a (cleaned) pebble or something else

Abbreviations (US Terms):

MR = magic ring

sc = single crochet

ch = chain

slst = slip stitch

st = stitch

sc3tog = crochet 3 single crochet together at once

The specifications of the wool and needle sizes are only examples/references. If You use other wool than specified, the figure will become taller or smaller. It's Your choice which wool you use. The needle size must be chosen to match the wool used.

ATTENTION: *This pattern is mostly crocheted in rows, At the end of each row, chain 1 and turn. If I forget to write it down please make it anyway :o)
If it's crocheted any other way, I'll write it down.*

Numbers of stitches and rows/rounds are given for furniture, but these are only examples. Other wool, different needle size and own crochet style will probably vary the size, in this case it depends mainly on the used cardboard sizes, how much has to be crocheted. However, it is very easy to adjust the size because only more or less stitches and rows have to be added, most of the pieces are crocheted without increases or decreases, so you only have to continue crocheting ahead or even stop earlier.

I hope, it's understandable and I'm really sorry if something sounds weird. 🤪

Rocking bear:

Head:

Fluffy yarn, hook 2.0 mm

Crochet in spirals

Make an oval (see image).

1. ch 5, sc 3, sc 3 in last stitch, rotate 180 degrees and crochet along the opposite side of the foundation chain:
sc 2, sc 2 in last chain (10)
2. inc, sc 2, inc x3, sc 2, inc x2 (16)
3. sc 1, inc, sc 2, (sc 1, inc) x3, sc 2, (sc 1, inc) x2 (22)
4. sc 2, inc, sc 2, (sc 2, inc) x3, (sc 2, inc) x2 (28)
5. sc 11, inc, sc 14, inc, sc 1 (30)
- 6.-7. (2 Rounds) sc in each st around (30)
8. sc 15, dec, sc 2, dec, sc 2, dec, sc 5 (27)
9. inc, sc 9, (sc 1, inc) x8, sc 1 (36)
10. sc 1, inc, sc 9, (sc 2, inc) x8, sc 1 (45)
11. (sc 14, inc) x3 (48)
12. (sc 7, inc) x6 (54)
- 13.-22. (10 Rounds) sc in each st around (54)

If you're using safety eyes, place it between round 10 and 11 with a distance of about 8-10 stitches. The best way to do this is to stuff the head, place markers and remove stuffing to fix the eyes.

23. (sc 7, dec) x6 (48)
24. sc in each st around (48)
25. (sc 6, dec) x6 (42)
26. (sc 5, dec) x6 (36)
27. (sc 4, dec) x6 (30)
28. (sc 3, dec) x6 (24)

Stuff and shape the head.

29. (sc 2, dec) x6 (18)
30. (sc 1, dec) x6 (12)

Crochet an oval

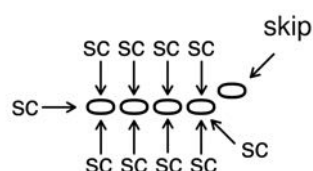

○ = chain
sc = single crochet

Stuff again if needed.

31. dec x6 (6)

Fasten off invisibly.

Ear (make 2):

Same yarn and needle as before.

Crochet in spirals.

1. sc 6 in MR (6)

2. inc x6 (12)

3. (sc 1, inc) x6 (18)

4.-6. (3 Rounds) sc in each st around (18)

Flatten the piece and crochet top edges together with single crochets.

Fasten off invisibly.

Nose:

black, hook size 2.0 mm

Crochet in spirals.

Make an oval again.

1. ch 4, sc 2, sc 3 in last stitch, rotate 180 degrees and crochet along the opposite side of the foundation chain: sc 1, sc 2 in last stitch (8)

2. inc, sc 1, inc x3, sc 1, inc x2 (14)

Fasten off, leave a long tail for sewing.

Body:

Same yarn and needle as the head.

Crochet in spirals

Make an oval again.

1. ch 6, sc 4, sc 3 in last stitch, rotate 180 degrees and crochet along the opposite side of the foundation chain: sc 3, sc 2 in last stitch (12)

2. inc, sc 3, inc x3, sc 3, inc x2 (18)

3. sc 1, inc, sc 3, (sc 1, inc) x3, sc 3, (sc 1, inc) x2 (24)

4. sc 2, inc, sc 3, (sc 2, inc) x3, sc 3, (sc 2, inc) x2 (30)

5. sc 3, inc, sc 3, (sc 3, inc) x3, sc 3, (sc 3, inc) x2 (36)

6. sc 4, inc, sc 3, (sc 4, inc) x3, sc 3, (sc 4, inc) x2 (42)

7.-26. (20 Rounds) sc in each st around (42)

27. (sc 5, dec) x6 (36)

28. (sc 4, dec) x6 (30)

29. (sc 3, dec) x6 (24)

Stuff and shape the body, put the pebble inside just before the end, Because the bear will otherwise fall on his nose as soon as he stands on the skids (the head is quite heavy), put some stuffing on top.

30. (sc 2, dec) x6 (18)

31. (sc 1, dec) x6 (12)

Add more stuffing if needed.

32. dec x6 (6)

Fasten off invisibly.

Leg (make 4):

Same yarn and needle as before.

Crochet in spirals.

1. sc 6 in MR (6)
2. inc x6 (12)
3. (sc 1, inc) x6 (18)
4. **BLO**: sc in each st around (18)
- 5.-8. (4 Rounds) sc in each st around (18)

Fasten off, don't close, stuff the leg.

Tail:

Same yarn and needle as before.

Crochet in spirals.

1. sc 6 in MR (6)
2. (sc 1, inc) x3 (9)
3. (sc 2, inc) x3 (12)
- 4.-5. (2 Rounds) sc in each st around (12)

Flatten the tail, crochet together with single crochets, don't stuff, leave a long tail for sewing.

Head shaping with eyes to sew on:

Mark the place for the eyes with pins first (between round 10 and 11 with a distance about 8-10 stitches). With a long needle with strong thread insert from the back of the head (select the position for the needle, where the head and body are sewn together later) and come out at the front of one of the eye marks, thread the eye, pierce through the same hole back to the back and come out 1 stitch away from the entry point. Now pull the eye inwards. The eye must be tightly fixed, repeat the procedure if you want and knot well (at least 3 times). Repeat the whole thing for the second eye.



Head shaping with safety eyes:

If you used safety eyes, the shape of the head becomes a little less beautiful, but it also works. Insert from the back of the head with the needle with strong thread and come out as close as possible to the eyes next to or a bit under the eye, go 1-2 stitches along the eye, insert the needle again and come out 1 stitch away from the entry point. Pull the eye inwards, knot well. Insert the needle again and go back to the same eye but this time come out on the opposite side and go back inside, come

out 1 stitch away from the entry point, also pull this side of the eye inwards and knot well. Repeat for the second eye.

Now place the nose, the bottom of the nose is touching the place between the 2nd and 3rd round, with the yarn tail of the nose sewing this stitch for stitch neatly, stuffing is not necessary. If there is still enough thread left, embroider the rest of the face, otherwise just use new thread.



Make a stitch with white thread underneath each eye, but the eyes have to be pulled very tightly so that the thread does not slip under the eye. To fix this thread permanently, apply a drop of glue under it.

The upper attachment point of the ears is placed between round 22 and 23, the lower one between round 17 and 18, between the upper points of the ears there are about 18 stitches.

Of course you can attach the ears wherever you want, my details are only examples.

Now place the legs under the body and sew on. Sew the tail to the back of the body.



If you like, you can stop here and have a cute baby bear, but if you want to make a rocking bear for Lilly, you need the **skids**.

As a base for the skids I used the sticks of popsicles (if you use thicker yarn the bear gets bigger, so popsicle sticks are not enough - maybe you can use some cardboard, wire, handicraft wood or something like that instead of these sticks). Soak the wooden sticks in water (preferably overnight, but at least 2-3 hours) so that they can absorb themselves well (possibly put in 1 or 2 sticks more, they break/split easily if you don't pay attention). If the sticks are well sucked up, you need a glass as straight as possible that matches the desired rounding of the sticks. Now pre-bend the sticks lightly and very carefully, especially at the ends, then press them into the

glass and let them dry completely. The bending can be reduced a little later if it becomes too much due to a smaller glass. Now crochet around the skids.

Skids:

beige, hook size 2.0 mm

Crochet in spirals.

You have to adjust the number of stitches and rounds if needed.

1. sc 6 in MR (6)
2. (sc 1, inc) x3 (9)
- 3.-32. (30 Rounds) sc in each st around (9)

Cut the yarn, insert the stick and fasten off invisibly.



Saddle:

light brown, hook size 2.0 mm

Crochet in spirals.

Make another oval.

Part 1:

1. ch 7, sc 4, sc 3 in last stitch, rotate 180 degrees and crochet along the opposite side of the foundation chain: sc 4, sc 2 in last stitch (14)
2. inc, sc 4, inc x3, sc 4, inc x2 (20)
3. sc 1, inc, sc 4, (sc 1, inc) x3, sc 4, (sc 1, inc) x2 (26)
4. sc 2, inc, sc 4, (sc 2, inc) x3, sc 4, (sc 2, inc) x2 (32)
5. sc 3, inc, sc 4, (sc 3, inc) x3, sc 4, (sc 3, inc) x2 (38)

Fasten off invisibly.

Part 2:

1. ch 7, sc 4, sc 3 in last stitch, rotate 180 degrees and crochet along the opposite side of the foundation chain: sc 4, sc 2 in last stitch (14)
2. inc, sc 4, inc x3, sc 4, inc x2 (20)
3. sc 1, inc, sc 4, (sc 1, inc) x3, sc 4, (sc 1, inc) x2 (26)
4. sc 2, inc, sc 4, (sc 2, inc) x3, sc 4, (sc 2, inc) x2 (32)
5. sc 3, inc, sc 4, (sc 3, inc) x3, sc 4, (sc 3, inc) x2 (38)

Don't fasten off, crochet in rows now:

6. **BLO:** sc 14, **both loops:** slst 1, ch 1, turn
7. skip 1 st, slst 1, sc 11, skip 1 st, slst 1, ch 1, turn
8. skip 1 st, slst 1, sc 9, skip 1 st, slst 1

Don't fasten off, Place both parts exactly on top of each other, the front side pointing outwards and crochet all around with slip stitches. Stuff loosely before final closing.

Fasten off, leave a long tail for sewing.

Now push a part of the stuffing a bit backwards into the heightening and fix it with a few stitches over the saddle.

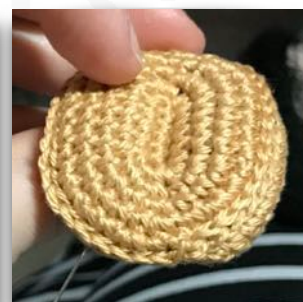

Girth:

Crochet a foundation chain with light brown (saddle color). It must run from one side of the saddle around the belly to the other side of the saddle (i. e. the places where the girth is to be sewn on), then crochet back with single crochets starting from the second chain from the hook. Place the belt around the belly, fix the saddle and belt to the bear with pins and sew on the belt to both sides of the saddle.

You can make a cord instead, I love the cords from Planet June [Video \(click\)](#).

Last but not least, all you have to do is sew the skids to the legs, then the rocking bear is ready for Lilly!



Armchair:

For the armchair I used a much smaller hook as recommended at the banderole (4-4,5 mm - I used 2.2 mm), so that the fabric does not become holes and is as stable as possible.

In order to adjust the size of the armchair to the corresponding doll, only the number of chains has to be adjusted at the beginning, the number of increases and decreases does not have to be changed, just crochet more or less stitches between.

The foundation chain should be at least one third to twice as long as the width of the doll's bottom. My numbers of stitches are only guidelines, it is absolutely necessary to check if they fit, otherwise it doesn't look so nice or Lilly cannot sit down.

Crochet the side panels last, because the number of chains is required and, if necessary, has to be adjusted to fit.

Seat:

ICE Yarn Magic Glitz, hook size 2.2 mm

Crochet in spirals.

Make an oval again, same think as above with more stitches.

1. ch 26, start from 2nd chain from hook: sc 24, sc 3 in last stitch, rotate 180 degrees and crochet along the opposite side of the foundation chain: sc 23, sc 2 in last stitch (52)
2. sc 3 in first stitch, sc 23, sc 3 in one stitch, sc 1, sc 3 in one stitch, sc 23, sc 3 in one stitch, sc 1 (60)
3. **BLO**: sc in each st around (60)
- 4.-23. (20 Rounds) sc in each st around (60)
24. **BLO**: sc3tog, sc 23, sc3tog, sc 1, sc3tog, sc 23, sc3tog, sc 1 (52) < — flatten to see how many stitches are needed and then crochet 1-2 sc as shift stitches up to the edge



25. sc 24, sc3tog, sc 23, dec

Fasten off, leave a long tail for sewing.

Cut the cardboard (or alternative material) to size, round off the corners slightly and put it in. Stuff the cushion on one side of the cardboard but not too tight. Sew the outer loops alternately together with the remaining thread, go in each loop from below/outside. Before closing, you may have to finish stuffing and pull it into the last corner.



Backrest:

Same yarn and hook as before.

Crochet in spirals.

Make an oval again.

The number of the foundation chain is the same as for the seat.

1. ch 26, start from 2nd chain from hook: sc 24, sc 3 in last stitch, rotate 180 degrees and crochet along the opposite side of the foundation chain: sc 23, sc 2 in last stitch (52)

2.-26. (25 Rounds) sc in each st around (52) < — *make 1-2 shift stitches here as well*

27. sc 24, sc3tog, sc 23, sc3tog (the 3rd one is the stitch of the next round)

Fasten off, leave a long tail for sewing.

Cut the cardboard to size, round off the corners slightly and put it in the backrest.

The backrest is also stuffed on one side of the cardboard, but a bit less than the seat cushion, very loosely at the top, because this side is sewn together with the seat cushion later, otherwise it isn't close together.

Close the opening same way as for the seat cushion before.



Armrest (make 2):

Same yarn and hook as before.

Crochet in spirals.

Make an oval again.

Check the number of stitches here, the foundation chain has to be as long as the side of the seat.

1. ch 26, start from 2nd chain from hook: sc 24, sc 3 in last stitch, rotate 180 degrees and crochet along the opposite side of the foundation chain: sc 23, sc 2 in last stitch (52)

2.-26. (25 Rounds) sc in each st around (52) < — *make 1-2 shift stitches here as well*

27. sc 24, sc3tog, sc 23, sc3tog (the 3rd one is the stitch of the next round)

Stuff the lower part of the armrest very loosely, the upper part is not stuffed (must be rolled). Flatten and crochet with single crochet.

Fasten off, leave a long tail for sewing.



Roll the unstuffed part up to about half of the armrest and fix it with pins. Sew the roll with the remaining thread, working all the way through the side and then through the rolled up part (see pictures), making sure that the stitches always stay in the same round so that it will be nice and straight. The more accurate you work, the more beautiful the result will be.

Make the second armrest the same way.



Cushion (large):

Same yarn and hook as before.

Crochet in spirals.

Make an oval again.

The number of stitches depends on the desired size for the cushion, the cushion becomes square.

1. ch 16, start from 2nd chain from hook: sc 14, sc 3 in last stitch, rotate 180 degrees and crochet along the opposite side of the foundation chain: sc 13, sc 2 in last stitch (32)

2.-14. (13 Rounds - adjust for the square if needed) sc in each st around (32)
make 1-2 shift stitches here as well

15. sc 14, sc3tog, sc 13, sc3tog (the 3rd one is the stitch of the next round)

Fasten off, leave a long tail for sewing. Stuff the cushion and close the opening the same way as the other parts of the armchair.

Cushion (small):

Same yarn and hook as before.

Crochet in spirals.

Make an oval again.

The number of stitches depends on the desired size for the cushion, the cushion becomes square.

1. ch 11, start from 2nd chain from hook: sc 9, sc 3 in last stitch, rotate 180 degrees and crochet along the opposite side of the foundation chain: sc 8, sc 2 in last stitch (22)

2.-9. (8 Rounds - adjust to make a square if needed) sc in each st around (22)
make 1-2 shift stitches here as well

10. sc 9, sc3tog, sc 8, sc3tog (the 3rd one is the stitch of the next round)

Fasten off, leave a long tail for sewing. Stuff the cushion and close the opening the same way as before.



Now the single parts for the armchair are ready and it can be built. Assemble the armchair (make sure that the cardboard points outwards) and fix it with pins (see pictures).

First, I sewed the backrest and seat cushion stitch by stitch carefully together.

On the armrests, I started at the back about halfway in the middle of the roll, sewing stitch by stitch together, first at the back, then at the bottom and finally at the front to the point where the seat is.

Here too, the more careful the work is, the better the result.



Finally the feet are sewn on, for this I have used wooden beads with a diameter of 25 mm, take care that they are placed evenly in each of the 4 corners and are sewn on tightly and do not wiggle.

That was it. Lilly's chair is ready. If you like, you can build her a cabinet now.

Kabinet:

First, the cardboard is cut to the required size. If you don't have a very stable cardboard, you can simply double-using the cardboard.



Here are my measures (adjusted to the size of my Lilly):

- 2 x 17cm x 10cm - Door and rear panel
- 2 x 10cm x 7.5cm - base and cover panel
- 2 x 17cm x 7.5cm - 2 side panels
- 2 x 9.5cm x 7cm - 2 shelves

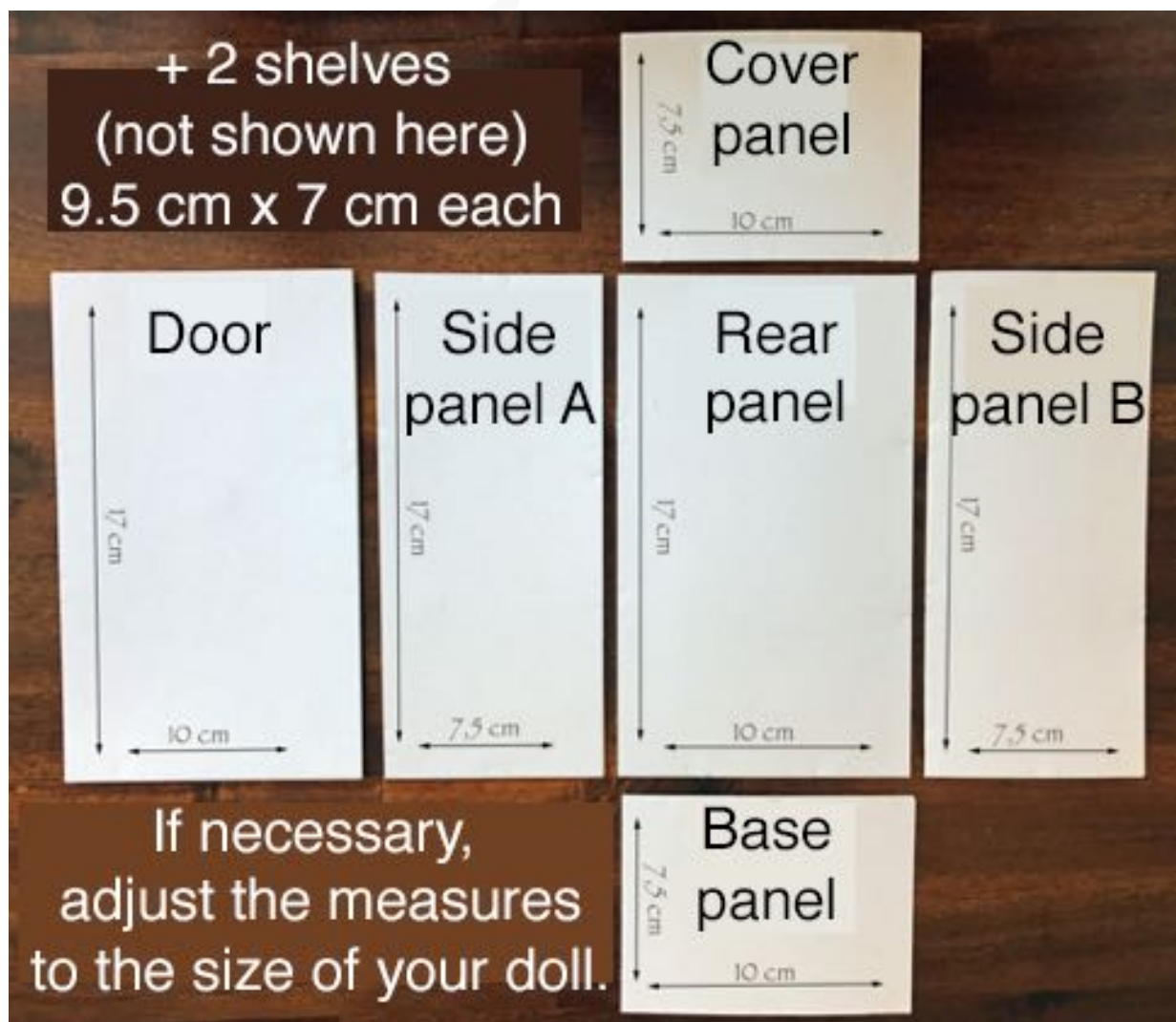

Door and rear panel:

Wool of choice, suitable hook size (as stated on the banderole)

Crochet an foundation chain that is a little bit longer than the long side of the corresponding carton piece, for me: ch 33, starting from 2nd chain from hook: sc 32, I've made 24 rows. For a nice result, the fabric should be at most as large as the cardboard part so that it fits well and is stable enough - the more elastic the fabric is, the smaller it should be. Check the width after a few rows. Once the number of stitches for a part has been found, it applies to all parts that have the same width. Crochet two of these rectangles each for door and rear panel, fasten off the first of the two rectangles, do not fasten off the second. Place the two pieces on top of each other, the active loop is at the back. Now go through the first stitch of the front piece and pull the loop through, sc all around, make 3 sc in each corner. Before closing the 4th side, insert the cardboard, close this row too. Fasten off invisibly.

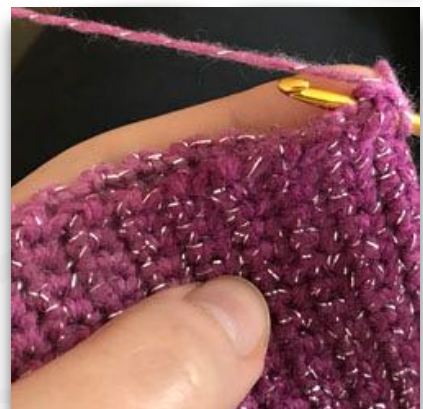
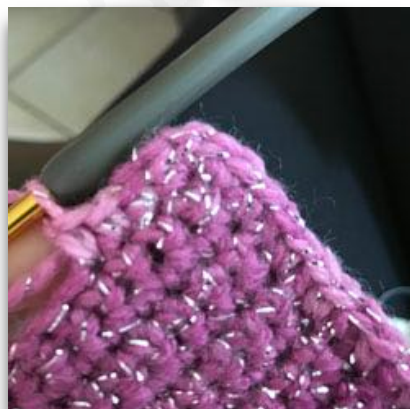

Side panel A & B, cover & base panel and 2 shelves:

Work all this pieces same way as door and rear panel, of course you have to use other numbers of chains. I list the numbers I used below:

- *Side panels: ch 33 and 18 rows*
- *cover and base panel: ch 20 and 18 rows*
- *shelves: ch 18 and 18 rows*

Don't forget: you have to make two pieces for each panel.

First of all, I put all parts together with pins (except for the shelves). It is a matter of taste on



which side the door is located and can be chosen later.

Hint: When crocheting the bedside table, I came up with a better method instead of the beads to hold the shelves. If you choose this method, you should do it before crocheting together all the pieces. After connecting the individual cabinet parts with pins, mark the positions for the shelves on both side walls. Make sure that the shelves will be really straight later. Remove the side panels and join at a marked point with a slipstitch. Crochet directly into the fabric with single crochets, ch 1, turn and make another row with single crochets, fasten off invisibly. Repeat for the other marked points. This method is much easier to make and looks more nicely.



Now the cabinet is going to be finally assembled. To do this, join in a new corner with a slipstitch, make sure that you always go through both stitches and always use the opposite ones. First I crocheted together the side panel with the cover, then along the back side and then the base panel. Then I repeated this on the opposite side as well, but I attached the door there too. Finally I closed the remaining open edges.



You can also do each page separately if you prefer. Always make sure that the stitches forming the corners are crocheted several times if needed so that no holes are created.

The number of stitches is not quite the same in the places where the back panel has to be connected to the base panel and the cover panel, because the crochet direction is not the same. In this case, the stitches in the base panel and cover panel must be crocheted several times at a suitable location to ensure that it is correct. However, you can see this well when crocheting, since nearly all parts are already connected with each other and you can see where it doesn't fit. The stitches to be connected must always be opposite each other.

Next, I sewed on the biggest beads as feet, one in each corner of the bottom. Make sure they are well sewn on, so they don't wiggle. As an alternative, the feet can also be crocheted - I would use a contrasting color.

I used a bead with a diameter of 20 mm now (a little smaller than the feet). Attach the handle in a suitable place, just as the feet before sewing well.

Close the door and mark the place where the loop for closing should be later. Join to this place with a slipstitch, Crochet so many chains that the loop around the handle is long enough (for me: ch 15), crochet with slipstitches along the chain, make a slipstitch in the starting stitch, fasten off invisibly.



If you don't use the more nice method for the shelf holders (as written above): put the shelves in the right places, mark the points for the beads, take care that the shelves will be straight. Remove the shelves and sew on the beads, 4 beads for each shelf.

Finally insert the shelves, then the cabinet is ready.





Nightstand:

First, cut the cardboard to the required size. The nightstand can be equipped with a shelf or a drawer.

These are my measurements (adapted to Lilly's bed from another pattern), probably you have to adjust it:

- 5x (5cm x 5cm) - 2 side panels, rear panel, base and cover panel
- with shelf (see picture):
 - 1x (4,5 x 4,5cm) - shelf
- with drawer:
 - 4x (4cm x 2cm) - side and front panels of the drawer
 - 1x (4cm x 4cm) - base panel of the drawer



Main panels (make 5):

Wool of choice, suitable hook size

Crochet in rows.

Make a foundation chain that is a little bit longer than the corresponding side of the cardboard part, I used Catania/Catona and hook size 2 mm:

1. ch 15, starting from 2nd chain from hook: sc 14 < — *adjust if needed*

2.-15. (14 Rows) sc 14 < — *also adjust if needed*

You need two of these crocheted squares per panel (I mostly used two different colors - except for the base and cover plate). Fasten off the first of these squares, do not fasten off the second square, put both squares on top of each other (the active one down/back), go through the first stitch of the upper/front square, pull through the active loop and continue crocheting with it, crochet around the panel with single crochets, sc 3 in each corner. Insert the cardboard before closing the 4th side, crochet this row, fasten off invisibly.



With shelf:

Shelve:

Wool of choice, suitable hook size

Crochet in rows.

Make a foundation chain that is a little bit longer than the corresponding side of the cardboard part, I used Catania/Catona and hook size 2 mm:

1. ch 15, starting from 2nd chain from hook: sc 14 < — *adjust if needed*

2.-14. (13 Rows) sc 13 < — *also adjust if needed*

Finish the same way as the main panels.

With drawer:

Side panel (make 4):

Wool of choice, suitable hook size

Crochet in rows.

Make a foundation chain that is a little bit longer than the corresponding side of the cardboard part, I used Catania/Catona and hook size 2 mm:

1. ch 13, starting from 2nd chain from hook: sc 12 < — *adjust if needed*

2.-6. (5 Rows) sc 12 < — *also adjust if needed*

Finish the same way as before.

Base panel:

Wool of choice, suitable hook size

Crochet in rows.

Make a foundation chain that is a little bit longer than the corresponding side of the cardboard part, I used Catania/Catona and hook size 2 mm:

1. ch 13, starting from 2nd chain from hook: sc 12 < — *adjust if needed*

2.-12. (11 Rows) sc 12 < — *also adjust if needed*

Finish the same way as before.

I assembled the drawer first. First fix the side pieces to the base plate using pins and then close one vertical and one horizontal seam per piece with the end threads of the side pieces, always go through the outer loops from the outside with the needle. Hide the yarn tails.



Next, assemble the five main plates for the bedside table and locate and mark a suitable position for the "holding rails" for the drawer or shelf, insert the drawer or shelf into the appropriate position and mark the row directly below it. Now dismount the nightstand and join with a slipstitch to the marker directly in the fabric. Crochet a row of single crochets directly into the fabric at the marker, ch 1, turn and crochet another row of single crochets. Proceed in the same way with the opposite side panel. This step is the same for both variants. Attach a button or a wooden bead (15-20 mm) to one side of the drawer as a handle.

Now put the parts of the nightstand together again using pins (take care of the side parts with the rails that they are both in the right position) and crochet or sew together. I have crocheted the joints around the base panel and the cover panel with one row of single crochets each. The last two seams at the back of the nightstand were sewn together, I only used the outer loops again. Finally I crocheted around the opening at the front with single crochets, but this step is optional.



If you have closed all seams, only the 4 wooden beads have to be sewn on as feet carefully, so that they don't wiggle. The required beads can also be crocheted alternatively.

That's it! :o)

